

PLAN OF SUBDIVISION		EDITION 1	PS837144H	
LOCATION OF LAND PARISH: CRANBOURNE TOWNSHIP: — SECTION: PART OF CROWN SECTION KNOWN AS CARDINIA CREEK PRE-EMPTIVE RIGHT CROWN ALLOTMENT: 73(PT) TITLE REFERENCE: VOL. FOL. LAST PLAN REFERENCE: PS837143K (LOT B) POSTAL ADDRESS: 70S SMITHS LANE <small>(at time of subdivision)</small> CLYDE NORTH 3978 MGA CO-ORDINATES: E: 358 980 ZONE: 55 <small>(of approx centre of land in plan)</small> N: 5 781 660 GDA 94		COUNCIL NAME: CITY OF CASEY		
VESTING OF ROADS AND/OR RESERVES		NOTATIONS		
IDENTIFIER	COUNCIL/BODY/PERSON	LOTS 1 TO 1000 (BOTH INCLUSIVE) HAVE BEEN OMITTED FROM THIS PLAN. FOR RESTRICTION A AFFECTING LOTS 1001 TO 1040 (BOTH INCLUSIVE) SEE SHEET 3. FOR RESTRICTION B AFFECTING LOTS 1025, 1035 & 1036 SEE SHEET 3. FOR RESTRICTION C AFFECTING LOTS 1002 TO 1005 (BOTH INCLUSIVE) SEE SHEET 3. OTHER PURPOSE OF PLAN: i) TO REMOVE THAT PART OF DRAINAGE EASEMENT CREATED AS E-1 ON PS837143K CONTAINED WITHIN BURNBANK PARADE AND SPECTRUM CRESCENT ON THIS PLAN. ii) TO REMOVE THAT SEWERAGE EASEMENT CREATED AS E-2 ON PS837143K CONTAINED WITHIN SPECTRUM CRESCENT ON THIS PLAN. GROUND FOR REMOVAL OF EASEMENT: AGREEMENT FROM ALL INTERESTED PARTIES (SECTION 6(1)K SUBDIVISION ACT 1988)		
ROAD R1	CITY OF CASEY			
NOTATIONS		DEPTH LIMITATION: DOES NOT APPLY This is a SPEAR plan. STAGING: This is not a staged subdivision. Planning Permit No. PInA00824/19 SURVEY: This plan is based on survey. This survey has been connected to permanent marks No(s). 68, 77 & 176 In Proclaimed Survey Area No. 71 <div style="border: 1px solid black; padding: 2px; font-size: small;"> Estate: Smiths Lane Phase No.: 10 No. of Lots: 40 + Lot D & G PHASE AREA: 2.641ha </div>		
NOTATIONS				
DEPTH LIMITATION: DOES NOT APPLY				
EASEMENT INFORMATION				
LEGEND: A - Appurtenant Easement E - Encumbering Easement or Condition in Crown Grant in the Nature of an Easement R - Encumbering Easement (Road)				
Easement Reference	Purpose	Width (Metres)	Origin	Land Benefited/In Favour Of
E-1	DRAINAGE	2	THIS PLAN	CITY OF CASEY
Beveridge Williams <small>development & environment consultants</small> Melbourne ph : 03 9524 8888 www.beveridgewilliams.com.au		SURVEYORS FILE REF: 1101438/10 1101438-10-PS-V3.DWG LICENSED SURVEYOR: JAMES ARTHUR WIGGINS VERSION 3, DATE: 15/10/2020	ORIGINAL SHEET SIZE: A3	SHEET 1 OF 3

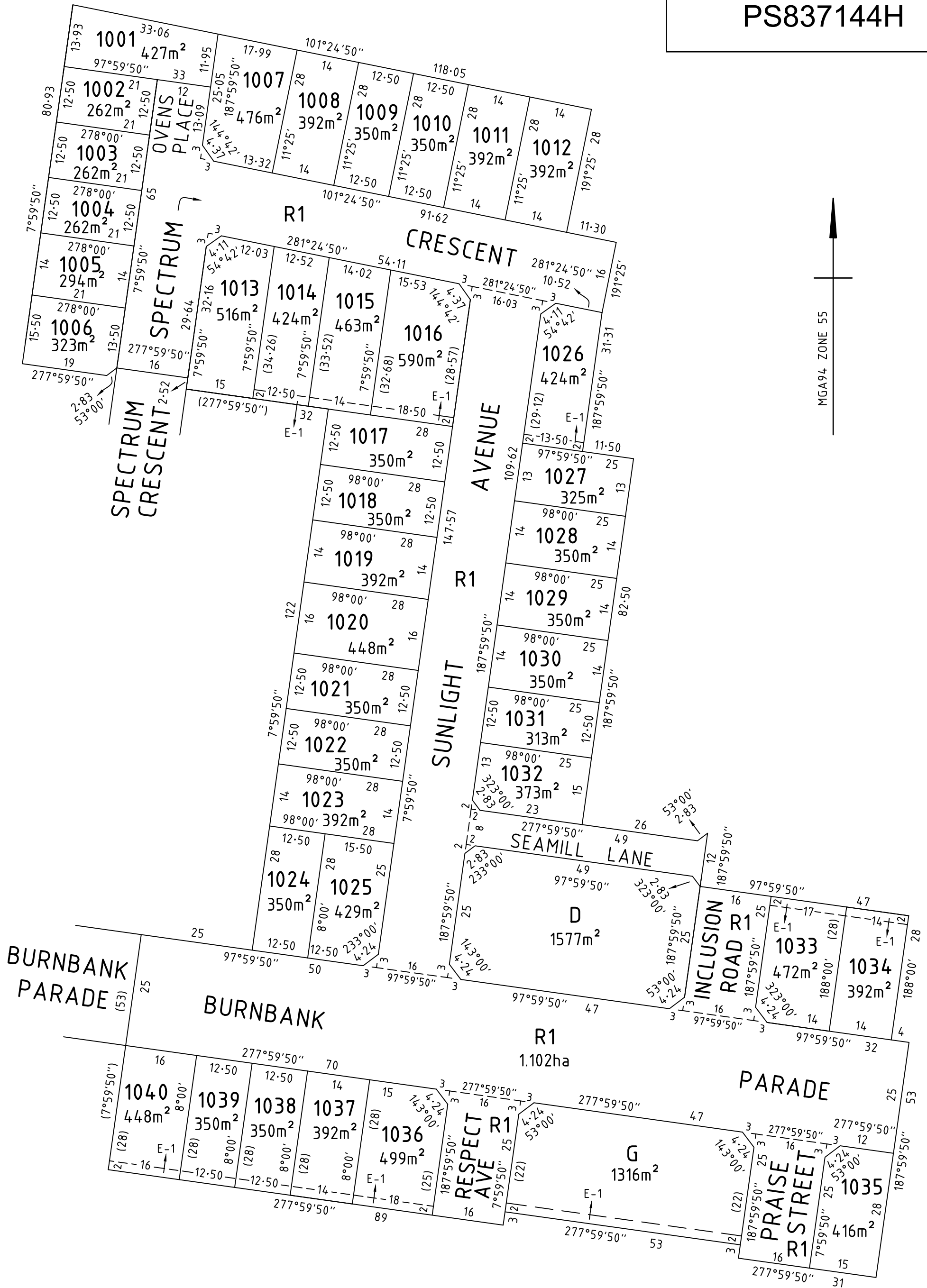

CREATION OF RESTRICTION 'A'

THE REGISTERED PROPRIETORS OF THE BURDENED LAND COVENANT WITH THE REGISTERED PROPRIETORS OF THE BENEFITED LAND AS SET OUT IN THE RESTRICTION WITH THE INTENT THAT THE BURDEN OF THE RESTRICTION RUNS WITH AND BINDS THE BURDENED LAND AND THE BENEFIT OF THE RESTRICTION IS ANNEXED TO AND RUNS WITH THE BENEFITED LAND.

LAND TO BE BURDENED: LOTS 1001 TO 1040 (BOTH INCLUSIVE)

LAND TO BE BENEFITED: LOTS 1001 TO 1040 (BOTH INCLUSIVE)

DESCRIPTION OF RESTRICTION

THE REGISTERED PROPRIETOR OR PROPRIETORS FOR THE TIME BEING OF ANY BURDENED LOT ON THIS PLAN MUST NOT BUILD OR PERMIT ANY OTHER PERSON UNDER ITS CONTROL OR DIRECTION TO:

- 1) CONSTRUCT OR ALLOW TO BE CONSTRUCTED ANY BUILDING, STRUCTURE OR FENCE OTHER THAN A BUILDING, STRUCTURE OR FENCE IN ACCORDANCE WITH THE DESIGN GUIDELINES ENDORSED BY THE CITY OF CASEY UNDER PLANNING PERMIT No. PInA00824/19.

A COPY OF THE DESIGN GUIDELINES IS AVAILABLE UPON REQUEST AT WEBSITE <https://portal.smithslane.mirvac.com>

- 2) CONSTRUCT OR ALLOW TO BE CONSTRUCTED ANY BUILDING OR STRUCTURE OUTSIDE THE BUILDING ENVELOPE APPLIED TO THE LOT ON THE BUILDING ENVELOPE PLAN ENDORSED UNDER PLANNING PERMIT No. PInA00824/19.

A COPY OF THE BUILDING ENVELOPE PLAN IS AVAILABLE UPON REQUEST AT WEBSITE <https://portal.smithslane.mirvac.com>

- 3) CONSOLIDATE OR SEEK TO CONSOLIDATE ANY BURDENED LOT WITH ANOTHER LOT OR PART OF A LOT.
- 4) SUBDIVIDE OR SEEK TO SUBDIVIDE ANY BURDENED LOT.

VARIATION

ANY VARIATION TO BUILDING ENVELOPES OR CONSENT TO BUILD OUTSIDE ANY BUILDING ENVELOPE WILL REQUIRE APPROVAL FROM THE CITY OF CASEY.

EXPIRY DATE

THIS RESTRICTION SHALL CEASE TO HAVE EFFECT TEN (10) YEARS AFTER THE DATE OF REGISTRATION OF THIS PLAN.

CREATION OF RESTRICTION 'B'

THE REGISTERED PROPRIETORS OF THE BURDENED LAND COVENANT WITH THE REGISTERED PROPRIETORS OF THE BENEFITED LAND AS SET OUT IN THE RESTRICTION WITH THE INTENT THAT THE BURDEN OF THE RESTRICTION RUNS WITH AND BINDS THE BURDENED LAND AND THE BENEFIT OF THE RESTRICTION IS ANNEXED TO AND RUNS WITH THE BENEFITED LAND.

LAND TO BE BURDENED: LOTS 1025, 1035 & 1036

LAND TO BE BENEFITED: LOTS 1001 TO 1040 (BOTH INCLUSIVE)

DESCRIPTION OF RESTRICTION

EXCEPT WITH THE WRITTEN CONSENT OF MIRVAC AND IN ALL OTHER INSTANCES THE WRITTEN CONSENT OF EACH AND EVERY REGISTERED PROPRIETOR OF A BENEFITING LOT ON THE PLAN OF SUBDIVISION THE REGISTERED PROPRIETOR OR PROPRIETORS FOR THE TIME BEING OF ANY BURDENED LOT ON THE PLAN OF SUBDIVISION SHALL NOT:

DOUBLE STOREY CONSTRUCTION

- 1) BUILD OR ALLOW TO BE BUILT ON THE LOT A DWELLING HOUSE UNLESS IT IS TWO (2) STOREYS.

EXPIRY DATE

THIS RESTRICTION SHALL CEASE TO HAVE EFFECT TEN (10) YEARS AFTER THE DATE OF REGISTRATION OF THIS PLAN.

CREATION OF RESTRICTION 'C'

THE REGISTERED PROPRIETORS OF THE BURDENED LAND COVENANT WITH THE REGISTERED PROPRIETORS OF THE BENEFITED LAND AS SET OUT IN THE RESTRICTION WITH THE INTENT THAT THE BURDEN OF THE RESTRICTION RUNS WITH AND BINDS THE BURDENED LAND AND THE BENEFIT OF THE RESTRICTION IS ANNEXED TO AND RUNS WITH THE BURDENED LAND.

LAND TO BE BURDENED: LOTS 1002 TO 1005 (BOTH INCLUSIVE)

LAND TO BE BENEFITED: LOTS 1001 TO 1040 (BOTH INCLUSIVE)

DESCRIPTION OF RESTRICTION

THE REGISTERED PROPRIETOR OR PROPRIETORS FOR THE TIME BEING OF ANY BURDENED LOT ON THIS PLAN SHALL NOT CONSTRUCT OR ALLOW TO BE CONSTRUCTED ANY BUILDING OR STRUCTURE OTHER THAN A BUILDING OR STRUCTURE THAT IS IN ACCORDANCE WITH A "TYPE A" LOT UNDER THE SMALL LOT HOUSING CODE PURSUANT TO CLAUSE 72.04 OF THE CASEY PLANNING SCHEME.

EXPIRY DATE

THIS RESTRICTION SHALL CEASE TO HAVE EFFECT TEN (10) YEARS AFTER THE DATE OF REGISTRATION OF THIS PLAN.



Beveridge Williams
development & environment consultants

Melbourne ph : 03 9524 8888

www.beveridgewilliams.com.au

SURVEYORS REF
1101438/10

ORIGINAL SHEET
SIZE: A3

SHEET 3

LICENSED SURVEYOR: JAMES ARTHUR WIGGINS
VERSION 3, DATE: 15/10/2020