

SMITHS LANE - MIRVAC BUILDING ENVELOPES

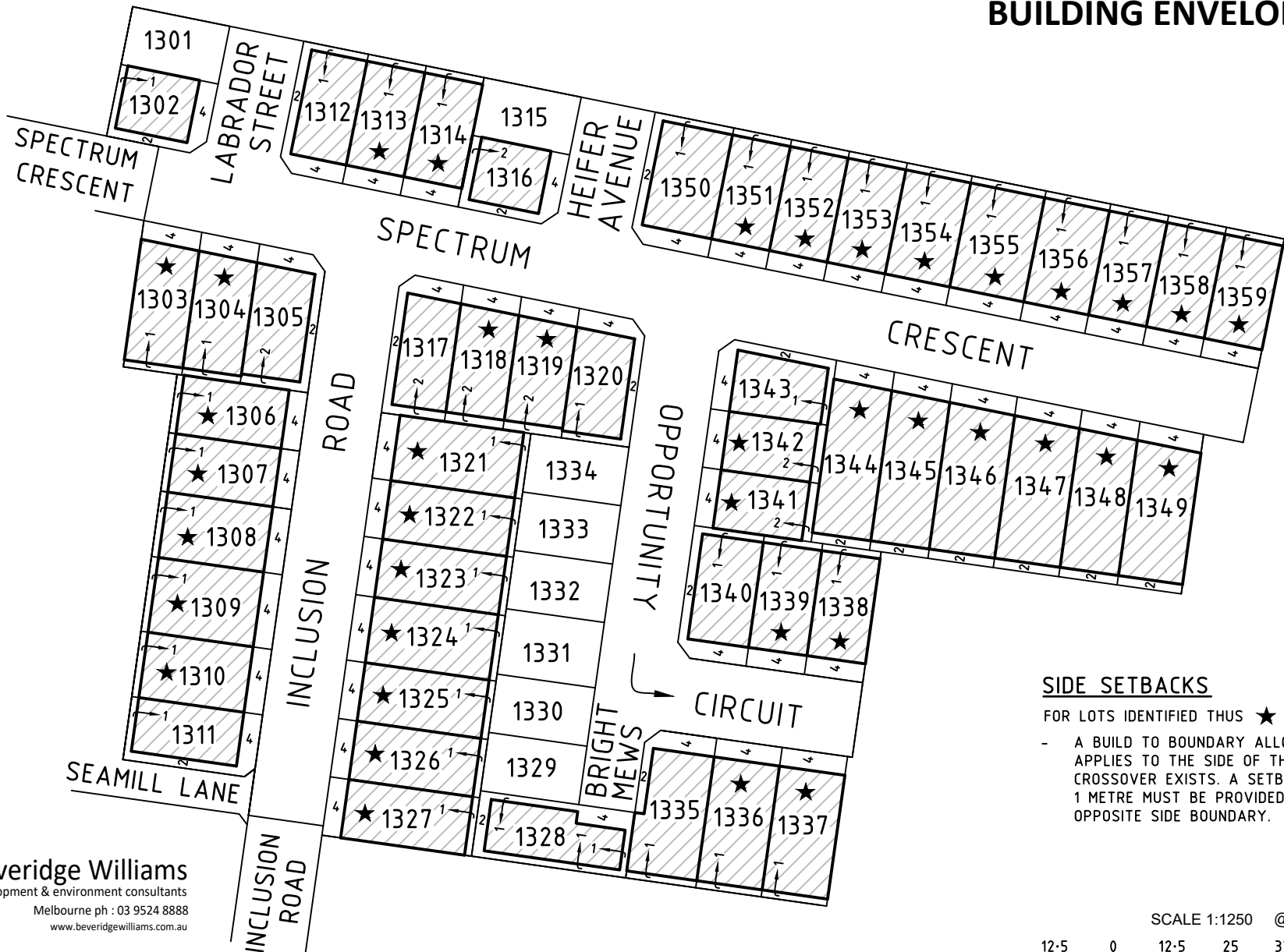

SIDE SETBACKS

FOR LOTS IDENTIFIED THUS ★

- A BUILD TO BOUNDARY ALLOWANCE ONLY APPLIES TO THE SIDE OF THE LOT WHERE THE CROSSOVER EXISTS. A SETBACK OF AT LEAST 1 METRE MUST BE PROVIDED FOR THE OPPOSITE SIDE BOUNDARY.



Beveridge Williams

development & environment consultants

Melbourne ph : 03 9524 8888

www.beveridgewilliams.com.au

Ref: 1101438/13 Ver B
1101438-13-BE-VerB.dwg

