

SMITHS LANE - MIRVAC BUILDING ENVELOPES

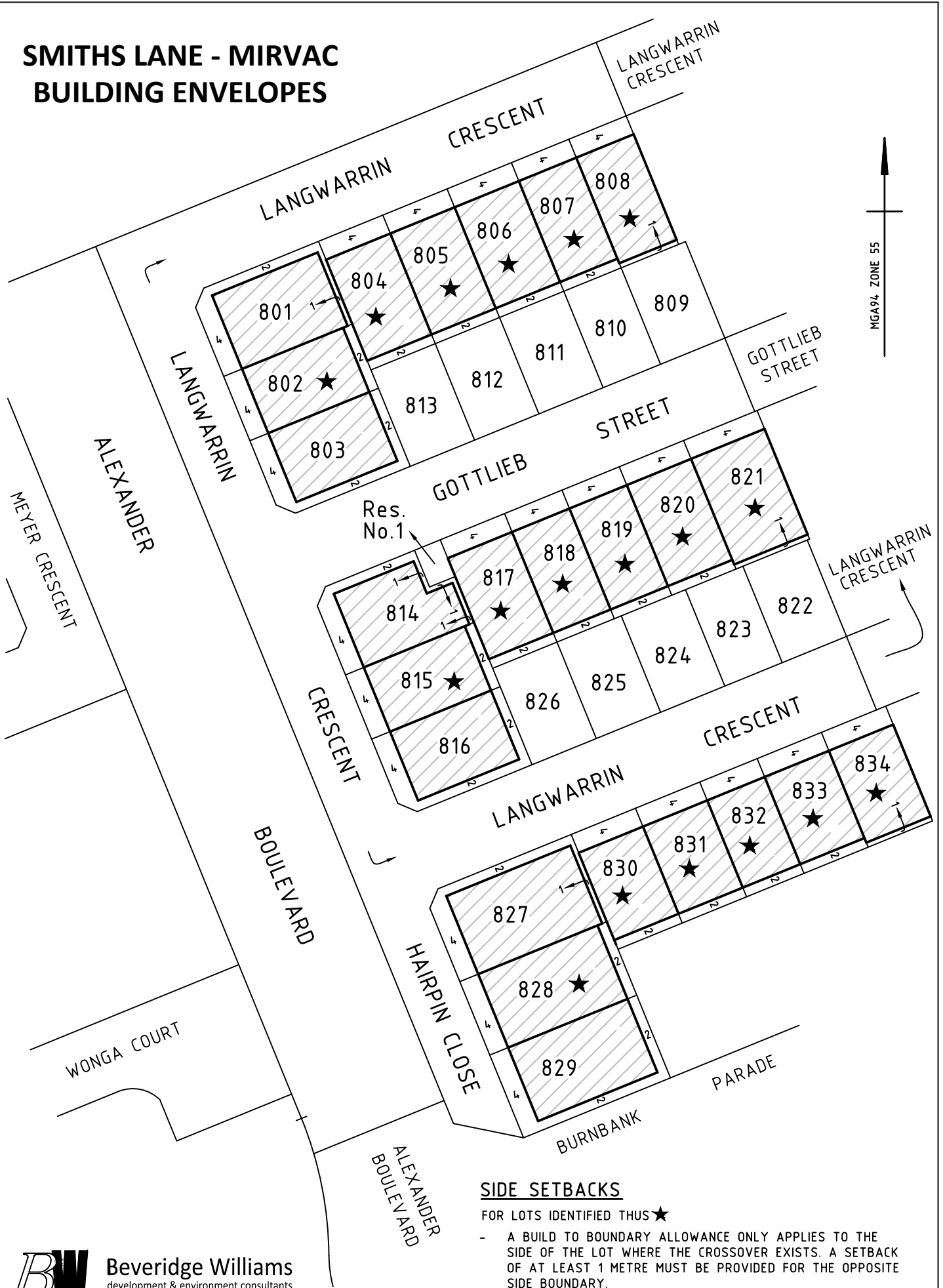

SIDE SETBACKS

FOR LOTS IDENTIFIED THUS ★

- A BUILD TO BOUNDARY ALLOWANCE ONLY APPLIES TO THE SIDE OF THE LOT WHERE THE CROSSOVER EXISTS. A SETBACK OF AT LEAST 1 METRE MUST BE PROVIDED FOR THE OPPOSITE SIDE BOUNDARY.

SCALE 1:1000 @ A4

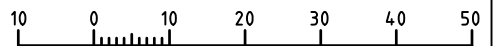

LENGTHS ARE IN METRES

Sheet 1 of 1



Beveridge Williams

development & environment consultants

Melbourne ph : 03 9524 8888

www.beveridgewilliams.com.au

Ref: 1101438/8 Ver C
1101438-08-BE-Ver C.dwg