



CIVIL GEOTECHNICAL SERVICES
ABN 26 474 013 724
PO Box 678 Croydon Vic 3136
Telephone: 9723 0744 Facsimile: 9723 0799

8th December 2021

Our Reference: 20295:NB875 (Rev.1)

Winslow Constructors Pty Ltd
50 Barry Road
CAMPBELLFIELD VIC 3061

Dear Sirs/Madams,

**RE: LEVEL 1 EARTHWORKS INSPECTION AND TESTING
SMITHS LANE – STAGE 10 (CLYDE NORTH)**

Please find attached our Report No's 20295/R001 to 20295/R006 which relate to the field density testing that was conducted within the filled allotments at the above subdivision. The level 1 inspections and associated field density testing was performed in May 2020.

The inspections and testing of the earthworks was undertaken in general accordance with the Level 1 requirements of AS 3798 - Guidelines on Earthworks for Commercial and Residential Developments.

The site inspection and testing was performed by experienced geotechnicians from this office. Any areas that were deemed unsatisfactory were reworked and retested under their supervision. The testing was performed to the relevant Australian Standards and the accompanying test reports carry NATA endorsement. The attached compaction results, which were located randomly throughout the fill profile, are considered to be representative of the bulk fill materials that were placed across the reported allotments by Winslow Constructors during the aforementioned period. The approximate locations of the field density tests can be seen on the attached plan (Figure 1).

We are of the view that the bulk fill materials that have been placed across the reported allotments by Winslow Constructors during the aforementioned period can be considered as having been placed in a controlled manner to a minimum density ratio of 95% (standard compactive effort).

Please contact the undersigned if you require any additional information.

Civil Geotechnical Services

A handwritten signature in blue ink, appearing to read 'Nick Brock', is written over a light blue circular stamp.

Nick Brock

FIGURE 1 (1 of 2)

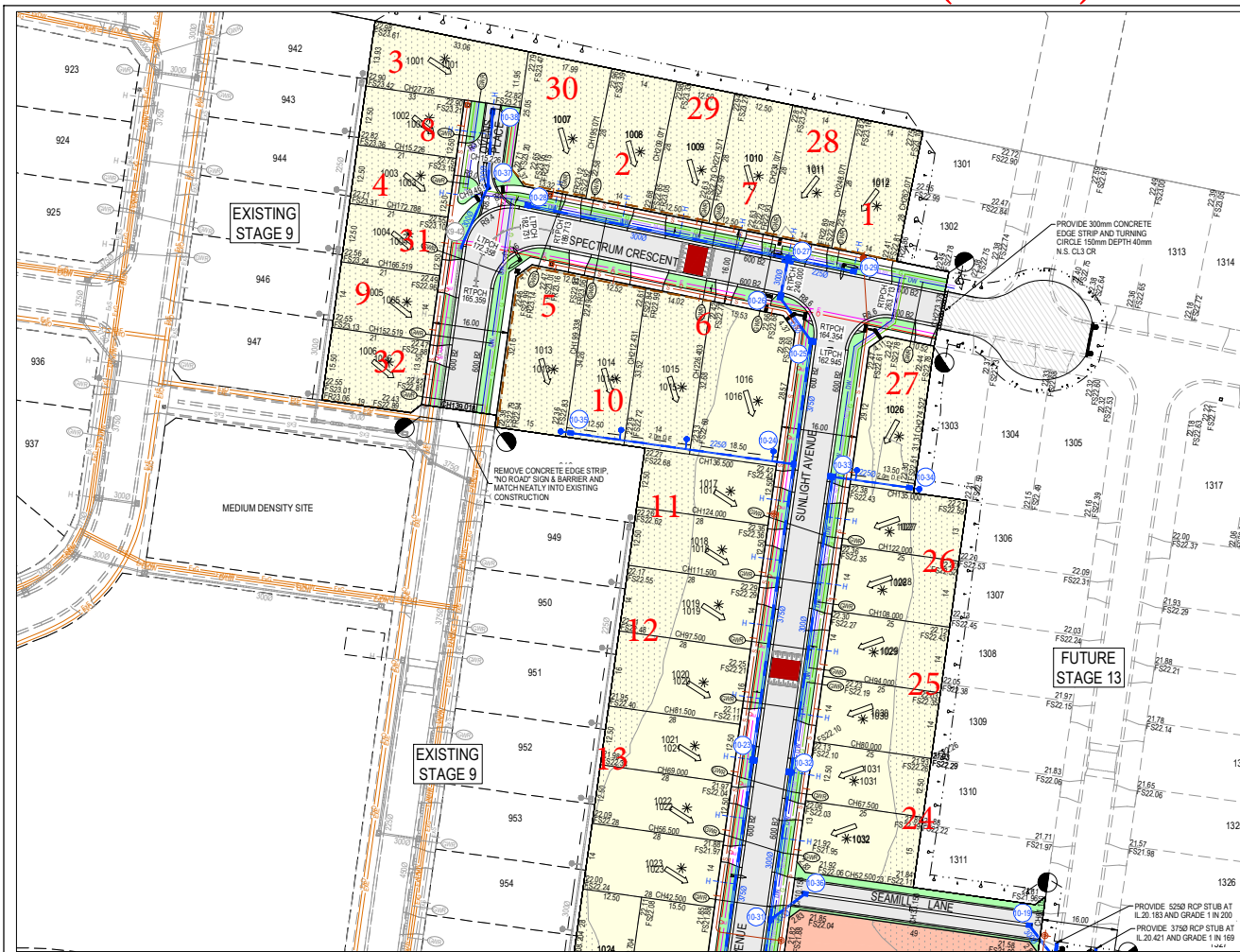

LEGEND - LAYOUT PLAN

- STORMWATER DRAIN, PIT & PROPERTY INLET
- MELBOURNE WATER DRAIN & PIT
- SWALE DRAIN
- SEWER & MAINTENANCE STRUCTURES
- HOUSE DRAIN
- SERVICE CONDUITS
- TACTILE PAVERS (INDICATIVE ONLY)
- ELECTRICITY (UNDERGROUND)
- ELECTRICITY (OVERHEAD)
- OPTIC FIBRE
- TELECOMMUNICATIONS
- GAS
- WATER
- RECYCLED WATER
- EXISTING ELECTRICITY (UNDERGROUND)
- EXISTING ELECTRICITY (OVERHEAD)
- EXISTING GAS
- EXISTING OPTIC FIBRE
- EXISTING TELECOMMUNICATIONS
- EXISTING WATER
- EXISTING RECYCLED WATER
- EXISTING STORMWATER DRAIN
- EXISTING SEWER
- EXISTING HOUSE DRAIN
- EXISTING SWALE DRAIN
- EXISTING SURFACE LEVEL
- FINISHED BUILDING LINE LEVEL
- FINISHED RIDGE LINE LEVEL
- TOP OF RETAINING WALL
- BOTTOM OF RETAINING WALL
- RIDGE LINE
- RETAINING WALL
- ZERO LOT LINES
- PAVEMENT TREATMENT
- STRUCTURAL FALL > 200mm DEEP
- EX STRUCTURAL FALL > 200mm DEEP
- DIRECTION OF FALL
- OVERLAND FLOW
- ALLOTMENT TO BE GRADED EVENLY IN
- DIRECTION OF FALL TO LEVELS INDICATED
- CONCRETE EDGE STRIP WITH SUBSOIL DRAIN
- "NO ROAD" SIGN & BARRIER
- LIMIT OF WORKS
- EXISTING TREE TO BE REMOVED
- PERMANENT SURVEY MARK
- TEMPORARY BENCH MARK
- PROPOSED DRIVEWAY
- TREE PROTECTION ZONE (TPZ)

Approximate field density test location

THE FINISHED SURFACE LEVELS, EXTENT OF FILL SHOWN ON THIS PLAN ARE PRELIMINARY ONLY, AND SHALL NOT BE FINALISED UNTIL CITY OF CASEY HAVE APPROVED THE PLANS FOR CONSTRUCTION

FOR CONTINUATION SEE SHEET 1101438-10-011

SERVICE OFFSET TABLE

Location	Gas		ND - Water		Water		Electricity		Telecommunication		Sewer		Irrigation	
	Side	Offset (m)	Side	Offset (m)	Side	Offset (m)	Side	Offset (m)	Side	Offset (m)	Side	Offset (m)	Side	Offset (m)
BURNBANK PARADE	S	2.25	S	2.70	S	3.20	N	2.60	N	1.85	NIS	1.00	N	6.70
SPECTRUM CRESCENT EW	N	2.25	N	2.70	N	3.20	S	2.60	S	1.85	NIS	0.80/1.00	-	-
SPECTRUM CRESCENT NS	E	2.25	E	2.70	E	3.20	W	2.60	W	1.85	W	0.80	-	-
SUNLIGHT AVENUE	E	2.25	E	2.70	E	3.20	W	2.60	W	1.85	EW	1.00	-	-
INCLUSION ROAD	E	2.25	E	2.70	E	3.20	W	2.60	W	1.85	W	1.00	-	-
PRAYSE STREET	W	2.25	W	2.70	W	3.20	E	2.60	E	1.85	-	-	-	-
RESPECT AVENUE	E	2.25	E	2.70	E	3.20	W	2.60	W	1.85	E	0.80	-	-
OVENS PLACE	W	2.25	W	2.70	W	3.20	E	0.50	E	1.25	W	0.80	-	-
SEAMILL LANE	-	-	-	-	-	-	-	-	-	-	-	-	-	-

NOTE: STREET TREES ARE TO BE PLANTED IN THE CENTRE OF ALL NATURE STRIPS

ROAD LAYOUT TABLE

ROAD NAME	RESERVE WIDTH (m)	ROAD WIDTH (m)			VERGE WIDTH (m)	
		LIP to LIP	INV to INV	BACK to BACK	NORTHWEST	SOUTHEAST
BURNBANK PARADE	25.00	6.40 (10.30)	7.30 (11.20)	7.60 (11.50)	10.70 (8.75)	6.70 (4.75)
SPECTRUM CRESCENT	16.00	6.40	7.30	7.60	4.35 (4.05)	4.50
SUNLIGHT AVENUE	16.00	6.40	7.30	7.60	4.20	4.50
INCLUSION ROAD	16.00	6.40	7.30	7.60	4.20	4.50
PRAYSE STREET	16.00	6.40	7.30	7.60	4.50	4.20
RESPECT AVENUE	16.00	6.40	7.30	7.60	4.20	4.50
OVENS PLACE	12.00	2.90 (5.00)	-	3.50 (5.60)	4.50	4.00 (1.90)
SEAMILL LANE	8.00	5.40	-	6.00	0.50	1.50

NOTE: DIMENSIONS IN PARENTHESES INCLUDES PARKING LANE

WARNING
BEWARE OF UNDERGROUND SERVICES
The locations of underground services are approximate only and their exact position should be proven on site.
No guarantee is given that all existing services are shown.
Locate all underground services before commencement of works
DIAL 1100 BEFORE YOU DIG
www.1100.com.au

FOR CONSTRUCTION

REV	DESCRIPTION	DATE	DRN	APP	REV	DESCRIPTION	DATE	DRN	APP
C	PIPE STRIP FOR 10-17 AMENDED	20/02/21	CD	LM					
B	PIPE STRIP FOR 10-17 AMENDED	10/02/21	CD	LM					
A	ISSUED FOR CONSTRUCTION	03/12/20	MS	LM					
P2	UPDATED DRAWING	19/11/20	MS	LM					
P1	ISSUED FOR INFORMATION	18/02/20	MS	LM	D	UPDATE LAYOUT	1/03/21	CD	LM

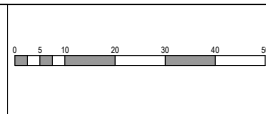

Designed Date: M.SORRI 15.10.20
Drawn: N.TABUENA
Approved Date: L.MURRAY 18.10.20
PS Number: PS8371448



Project Details: SMITHS LANE STAGE 10 CITY OF CASEY, R5501
Drawing Title: LAYOUT PLAN (SHEET 1 OF 2)

Sheet 04 of 25
Scale: 1:500 @ A1
Project Ref: 1101438 Stage No: 10 Drawing No: 010 Rev: D

FIGURE 1 (2 of 2)

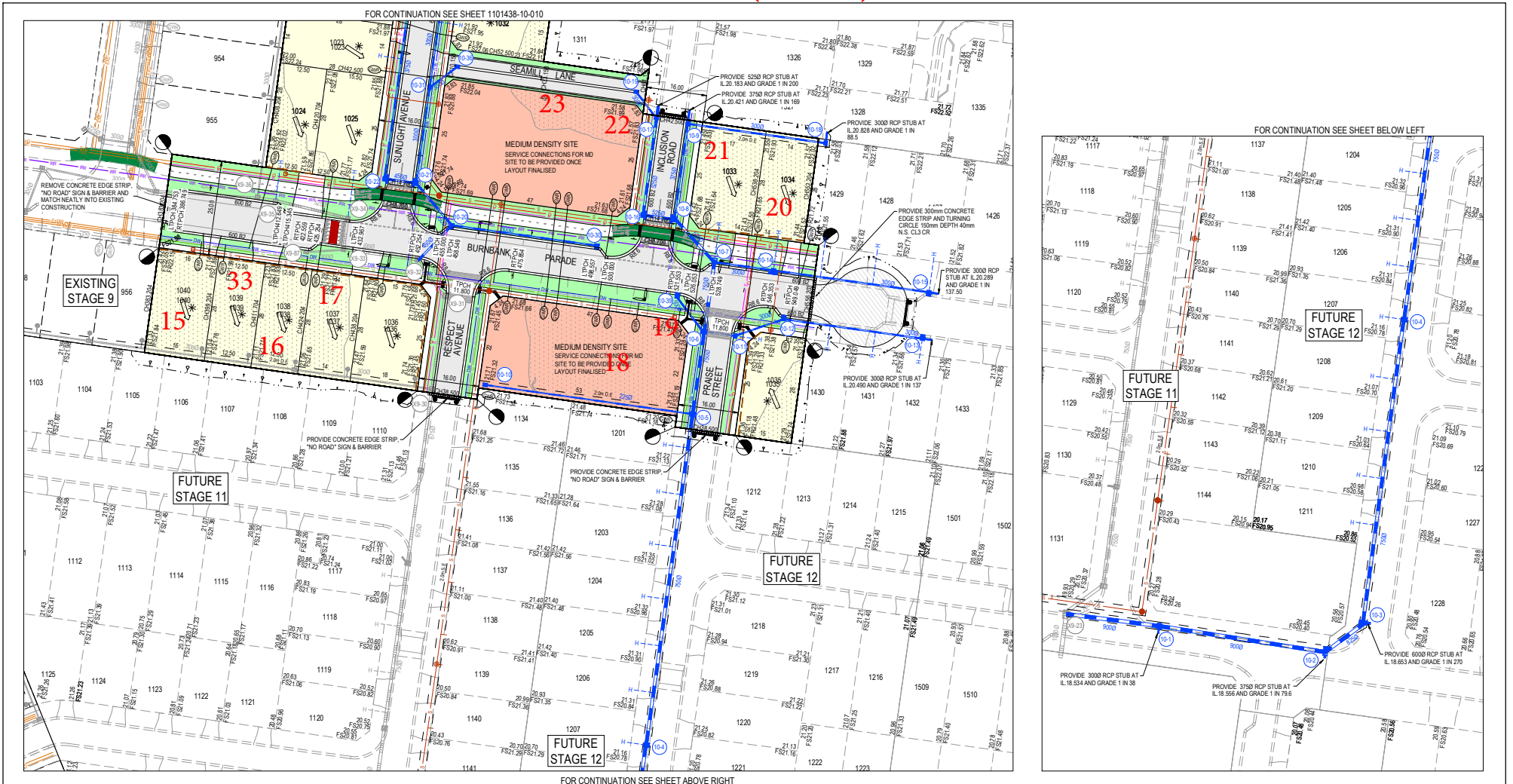

Approximate field density test location

WARNING
BEWARE OF UNDERGROUND SERVICES
 The locations of underground services are approximate only and their exact position should be proven on site.
 No guarantee is given that all existing services are shown.
 Locate all underground services BEFORE commencement of works
DIAL 1100 BEFORE YOU DIG
 www.1100.com.au

LEGEND - LAYOUT PLAN

<ul style="list-style-type: none"> STORMWATER DRAIN, PIT & PROPERTY INLET MELBOURNE WATER DRAIN & PIT SWALE DRAIN SEWER & MAINTENANCE STRUCTURES HOUSE DRAIN SERVICE CONDUITS ELECTRICITY (UNDERGROUND) ELECTRICITY (OVERHEAD) OPTIC FIBRE TELECOMMUNICATIONS GAS WATER RECYCLED WATER 	<ul style="list-style-type: none"> EXISTING STORMWATER DRAIN EXISTING ELECTRICITY (UNDERGROUND) EXISTING ELECTRICITY (OVERHEAD) EXISTING GAS EXISTING OPTIC FIBRE EXISTING TELECOMMUNICATIONS EXISTING WATER EXISTING RECYCLED WATER EXISTING SEWER EXISTING HOUSE DRAIN EXISTING SWALE DRAIN TACTILE PAVERS (INDICATIVE ONLY) 	<ul style="list-style-type: none"> EXISTING SURFACE LEVEL FINISHED BUILDING LEVEL FINISHED RIDGE LINE LEVEL TOP OF RETAINING WALL BOTTOM OF RETAINING WALL RIDGE LINE RETAINING WALL ZERO LOT LINES PAVEMENT TREATMENT STRUCTURAL FILL > 200mm DEEP EX. STRUCTURAL FILL > 200mm DEEP 	<ul style="list-style-type: none"> DIRECTION OF FALL OVERLAND FLOW ALLOWMENT TO BE GRADED EVENLY IN DIRECTION OF FALL TO LEVELS INDICATED CONCRETE EDGE STRIP WITH SUBSOIL DRAIN NO ROAD SIGN & BARRIER LIMIT OF WORKS EXISTING TREE TO BE REMOVED PERMANENT SURVEY MARK TEMPORARY BENCH MARK PROPOSED DRIVEWAY TREE PROTECTION ZONE (TPZ)
---	--	---	---

REV	DESCRIPTION	DATE	DRN	APP	REV	DESCRIPTION	DATE	DRN	APP
C	PIPE STUBS FOR 10/17 AMENDED	10/20/21	CD	LM	H	DRAWING INDEX UPDATED	05/08/21	LM	DR
B	PIPE STUBS FROM 10/3 AMENDED	10/12/20	MB	LM	G	UPDATE LOT LEVELS	1/03/21	CD	LM
A	ISSUED FOR CONSTRUCTION	03/12/20	MB	LM	F	PIPE BETWEEN 10/2 & 10/3 REDUCED TO 10/20S	25/02/21	CD	LM
P2	UPDATED DRAWING	10/11/20	MB	LM	E	10/11/20 PIPE AMENDMENTS & PIPE 10/2 TO 10/3 REDUCED	23/02/21	CD	LM
P1	ISSUED FOR INFORMATION	18/02/20	MB	LM	D	PIPE STUB FOR 10/17 AMENDED	12/02/21	CD	LM



Drawn: N. TABUENA Approved: L. MURRAY Date: 18/10/20 PS Number: PS837144H	M.SORRI 15/10/20 1 Glenferrie Road Glenferrie VIC 3144 ph: 03 9524 8888 www.beveridgewilliams.com.au
--	---

BW Beveridge Williams

Project Details: SMITHS LANE STAGE 10 CITY OF CASEY, R5501 Drawing Title: LAYOUT PLAN (SHEET 2 OF 2)	Sheet 05 of 25 Scale: 1:500 @ A1 Project Ref: 1101438 Stage No: 10 Drawing No: 011 Rev: H
--	---

FOR CONSTRUCTION

Sheet 05 of 25

Scale: 1:500 @ A1

Project Ref: 1101438 Stage No: 10 Drawing No: 011 Rev: H

K:\Jobs Case\1101438\1101438-10-Smiths Lane, Casey (MRRAC), Eng\Stage 10\Drawings\1101438-10-10-LAY.dwg



COMPACTION ASSESSMENT

Job No 20295
 Report No 20295/R001
 Date Issued 18/08/2020

CIVIL GEOTECHNICAL SERVICES

6 - 8 Rose Avenue, Croydon 3136

Client	WINSLOW CONSTRUCTORS PTY LTD (CAMPBELLFIELD)	Tested by	SB
Project	SMITHS LANE - STAGE 10	Date tested	18/05/20
Location	CLYDE NORTH	Checked by	JHF

Feature	EARTHWORKS	Layer thickness	200 mm	Time: 13:00
----------------	-------------------	-----------------	--------	-------------

Test procedure AS 1289.2.1.1 & 5.8.1

Test No	1	2	3	4	5	6
Location	REFER TO FIGURE 1	REFER TO FIGURE 1	REFER TO FIGURE 1	REFER TO FIGURE 1	REFER TO FIGURE 1	REFER TO FIGURE 1
Approximate depth below FSL						
Measurement depth mm	175	175	175	175	175	175
Field wet density t/m³	1.99	1.98	1.93	1.93	1.96	1.98
Field moisture content %	15.9	20.8	17.0	18.7	20.5	25.9

Test procedure AS 1289.5.7.1

Test No	1	2	3	4	5	6
Compactive effort	Standard					
Oversize rock retained on sieve mm	19.0	19.0	19.0	19.0	19.0	19.0
Percent of oversize material wet	0	0	0	0	0	0
Peak Converted Wet Density t/m³	2.01	2.01	1.95	1.96	1.99	2.01
Adjusted Peak Converted Wet Density t/m³	-	-	-	-	-	-
Optimum Moisture Content %	18.0	23.0	19.5	21.0	18.0	28.5

Moisture Variation From Optimum Moisture Content	2.0% dry	2.0% dry	2.5% dry	2.5% dry	2.5% wet	2.5% dry
--	----------	----------	----------	----------	----------	----------

Density Ratio (R_{HD})	%	99.0	98.5	99.0	98.5	98.5	98.5
---	----------	-------------	-------------	-------------	-------------	-------------	-------------

Material description

No 1 - 6 Clay Fill

AVRLOT HILF V1.10 MAR 13



The results of the tests, calibrations and/or measurements included in this document are traceable to Australian/national standards. Accredited for compliance with ISO/IEC 17025 - Testing

Accreditation No 9909

Approved Signatory : Justin Fry



COMPACTION ASSESSMENT

Job No 20295
 Report No 20295/R002
 Date Issued 04/02/2021

CIVIL GEOTECHNICAL SERVICES

6 - 8 Rose Avenue, Croydon 3136

Client	WINSLOW CONSTRUCTORS PTY LTD (CAMPBELLFIELD)	Tested by	SB
Project	SMITHS LANE - STAGE 10	Date tested	19/05/20
Location	CLYDE NORTH	Checked by	JHF

Feature	EARTHWORKS	Layer thickness	200 mm	Time: 12:00
----------------	-------------------	-----------------	--------	-------------

Test procedure AS 1289.2.1.1 & 5.8.1

Test No	7	8	9	10	11	12
Location	REFER TO FIGURE 1	REFER TO FIGURE 1	REFER TO FIGURE 1	REFER TO FIGURE 1	REFER TO FIGURE 1	REFER TO FIGURE 1
Approximate depth below FSL						
Measurement depth mm	175	175	175	175	175	175
Field wet density t/m³	2.14	2.17	2.14	2.05	2.05	2.05
Field moisture content %	17.4	17.1	15.2	17.3	16.8	16.8

Test procedure AS 1289.5.7.1

Test No	7	8	9	10	11	12
Compactive effort	Standard					
Oversize rock retained on sieve mm	19.0	19.0	19.0	19.0	19.0	19.0
Percent of oversize material wet	0	0	0	0	0	0
Peak Converted Wet Density t/m³	2.18	2.22	2.18	2.09	2.09	2.10
Adjusted Peak Converted Wet Density t/m³	-	-	-	-	-	-
Optimum Moisture Content %	17.5	16.5	15.0	17.5	18.0	17.0

Moisture Variation From Optimum Moisture Content	0.0%	0.5% wet	0.0%	0.0%	1.0% dry	0.0%
--	------	----------	------	------	----------	------

Density Ratio (R_{HD})	%	98.0	97.5	98.0	98.0	98.0	98.0
---	----------	-------------	-------------	-------------	-------------	-------------	-------------

Material description

No 7 - 12 Clay Fill

AVRLOT HILF V1.10 MAR 13



The results of the tests, calibrations and/or measurements included in this document are traceable to Australian/national standards. Accredited for compliance with ISO/IEC 17025 - Testing

Accreditation No 9909

Approved Signatory : Justin Fry



COMPACTION ASSESSMENT

Job No 20295
 Report No 20295/R003
 Date Issued 04/02/2021

CIVIL GEOTECHNICAL SERVICES

6 - 8 Rose Avenue, Croydon 3136

Client	WINSLOW CONSTRUCTORS PTY LTD (CAMPBELLFIELD)	Tested by	SB
Project	SMITHS LANE - STAGE 10	Date tested	20/05/20
Location	CLYDE NORTH	Checked by	JHF

Feature	EARTHWORKS	Layer thickness	200 mm	Time: 12:30
---------	------------	-----------------	--------	-------------

Test procedure AS 1289.2.1.1 & 5.8.1

Test No	13	14	15	16	17	18	
Location	REFER TO FIGURE 1	REFER TO FIGURE 1	REFER TO FIGURE 1	REFER TO FIGURE 1	REFER TO FIGURE 1	REFER TO FIGURE 1	
Approximate depth below FSL							
Measurement depth	mm	175	175	175	175	175	
Field wet density	t/m ³	2.05	2.00	2.01	2.00	1.98	2.07
Field moisture content	%	12.3	11.8	11.0	15.1	17.1	15.4

Test procedure AS 1289.5.7.1

Test No	13	14	15	16	17	18
Compactive effort	Standard					
Oversize rock retained on sieve	mm	19.0	19.0	19.0	19.0	19.0
Percent of oversize material	wet	0	0	0	0	0
Peak Converted Wet Density	t/m ³	2.09	2.05	2.07	2.05	2.06
Adjusted Peak Converted Wet Density	t/m ³	-	-	-	-	-
Optimum Moisture Content	%	14.5	14.0	13.0	15.0	17.0

Moisture Variation From Optimum Moisture Content	2.0% dry	2.0% dry	2.0% dry	0.0%	0.0%	0.0%
--	----------	----------	----------	------	------	------

Density Ratio (R _{HD})	%	98.0	97.5	97.0	97.5	96.0	100.5
-----------------------------------	---	------	------	------	------	------	-------

Material description

No 13 - 18 Clay Fill

AVRLOT HILF V1.10 MAR 13



The results of the tests, calibrations and/or measurements included in this document are traceable to Australian/national standards. Accredited for compliance with ISO/IEC 17025 - Testing

Accreditation No 9909

Approved Signatory : Justin Fry



COMPACTION ASSESSMENT

Job No 20295
 Report No 20295/R004
 Date Issued 04/02/2021

CIVIL GEOTECHNICAL SERVICES

6 - 8 Rose Avenue, Croydon 3136

Client	WINSLOW CONSTRUCTORS PTY LTD (CAMPBELLFIELD)	Tested by	SB
Project	SMITHS LANE - STAGE 10	Date tested	21/05/20
Location	CLYDE NORTH	Checked by	JHF

Feature	EARTHWORKS	Layer thickness	200 mm	Time: 13:00
---------	------------	-----------------	--------	-------------

Test procedure AS 1289.2.1.1 & 5.8.1

Test No	19	20	21	22	23	24
Location	REFER TO FIGURE 1	REFER TO FIGURE 1	REFER TO FIGURE 1	REFER TO FIGURE 1	REFER TO FIGURE 1	REFER TO FIGURE 1
Approximate depth below FSL						
Measurement depth	mm	175	175	175	175	175
Field wet density	t/m ³	2.14	2.17	2.05	2.04	2.05
Field moisture content	%	11.9	13.3	14.2	12.1	11.9

Test procedure AS 1289.5.7.1

Test No	19	20	21	22	23	24
Compactive effort	Standard					
Oversize rock retained on sieve	mm	19.0	19.0	19.0	19.0	19.0
Percent of oversize material	wet	0	0	0	0	0
Peak Converted Wet Density	t/m ³	2.19	2.21	2.09	2.09	2.12
Adjusted Peak Converted Wet Density	t/m ³	-	-	-	-	-
Optimum Moisture Content	%	9.5	11.0	12.0	10.0	9.5

Moisture Variation From Optimum Moisture Content	2.5% wet	2.5% wet	2.0% wet	2.0% wet	2.5% wet	2.5% wet
--	----------	----------	----------	----------	----------	----------

Density Ratio (R _{HD})	%	98.0	98.0	98.0	97.5	98.0	97.5
-----------------------------------	---	------	------	------	------	------	------

Material description

No 19 - 24 Clay Fill

AVRLOT HILF V1.10 MAR 13



The results of the tests, calibrations and/or measurements included in this document are traceable to Australian/national standards. Accredited for compliance with ISO/IEC 17025 - Testing

Accreditation No 9909

Approved Signatory : Justin Fry



COMPACTION ASSESSMENT

Job No 20295
 Report No 20295/R005
 Date Issued 04/02/2021

CIVIL GEOTECHNICAL SERVICES

6 - 8 Rose Avenue, Croydon 3136

Client	WINSLOW CONSTRUCTORS PTY LTD (CAMPBELLFIELD)	Tested by	SB
Project	SMITHS LANE - STAGE 10	Date tested	22/05/20
Location	CLYDE NORTH	Checked by	JHF

Feature	EARTHWORKS	Layer thickness	200 mm	Time: 11:00
---------	------------	-----------------	--------	-------------

Test procedure AS 1289.2.1.1 & 5.8.1

Test No	25	26	27	28	29	30
Location	REFER TO FIGURE 1	REFER TO FIGURE 1	REFER TO FIGURE 1	REFER TO FIGURE 1	REFER TO FIGURE 1	REFER TO FIGURE 1
Approximate depth below FSL						
Measurement depth	mm	175	175	175	175	175
Field wet density	t/m ³	2.07	2.08	2.01	2.00	2.01
Field moisture content	%	20.5	16.6	17.4	15.4	17.1

Test procedure AS 1289.5.7.1

Test No	25	26	27	28	29	30
Compactive effort	Standard					
Oversize rock retained on sieve	mm	19.0	19.0	19.0	19.0	19.0
Percent of oversize material	wet	0	0	0	0	0
Peak Converted Wet Density	t/m ³	2.13	2.14	2.05	2.05	2.05
Adjusted Peak Converted Wet Density	t/m ³	-	-	-	-	-
Optimum Moisture Content	%	18.5	15.0	15.5	13.0	14.5

Moisture Variation From Optimum Moisture Content	2.0% wet	1.5% wet	2.0% wet	2.5% wet	2.5% wet	2.5% wet
--	----------	----------	----------	----------	----------	----------

Density Ratio (R _{HD})	%	97.5	97.0	98.0	97.5	98.0	98.0
-----------------------------------	---	------	------	------	------	------	------

Material description

No 25 - 30 Clay Fill

AVRLOT HILF V1.10 MAR 13



The results of the tests, calibrations and/or measurements included in this document are traceable to Australian/national standards. Accredited for compliance with ISO/IEC 17025 - Testing

Accreditation No 9909

Approved Signatory : Justin Fry



COMPACTION ASSESSMENT

Job No 20295
 Report No 20295/R006
 Date Issued 04/02/2021

CIVIL GEOTECHNICAL SERVICES

6 - 8 Rose Avenue, Croydon 3136

Client	WINSLOW CONSTRUCTORS PTY LTD (CAMPBELLFIELD)	Tested by	SB
Project	SMITHS LANE - STAGE 10	Date tested	24/05/20
Location	CLYDE NORTH	Checked by	JHF

Feature	EARTHWORKS	Layer thickness	200 mm	Time: 10:30
---------	------------	-----------------	--------	-------------

Test procedure AS 1289.2.1.1 & 5.8.1

Test No	31	32	33	-	-	-
Location	REFER TO FIGURE 1	REFER TO FIGURE 1	REFER TO FIGURE 1			
Approximate depth below FSL						
Measurement depth	mm	175	175	175	-	-
Field wet density	t/m ³	2.00	2.01	1.99	-	-
Field moisture content	%	14.5	13.6	13.5	-	-

Test procedure AS 1289.5.7.1

Test No	31	32	33	-	-	-
Compactive effort	Standard					
Oversize rock retained on sieve	mm	19.0	19.0	19.0	-	-
Percent of oversize material	wet	0	0	0	-	-
Peak Converted Wet Density	t/m ³	2.07	2.08	2.07	-	-
Adjusted Peak Converted Wet Density	t/m ³	-	-	-	-	-
Optimum Moisture Content	%	16.0	11.5	16.0	-	-

Moisture Variation From Optimum Moisture Content	1.5% dry	2.0% wet	2.5% dry	-	-	-
--	----------	----------	----------	---	---	---

Density Ratio (R _{HD})	%	97.0	96.5	96.5	-	-
-----------------------------------	---	------	------	------	---	---

Material description

No 31 - 33 Clay Fill

AVRLOT HILF V1.10 MAR 13



The results of the tests, calibrations and/or measurements included in this document are traceable to Australian/national standards. Accredited for compliance with ISO/IEC 17025 - Testing

Accreditation No 9909

Approved Signatory : Justin Fry